

ADPK14 – 14mm Fastflo™ in low-profile diffuser panels in an acoustic floating floor with Knauf board*

* Can be purchased from Nu-Heat

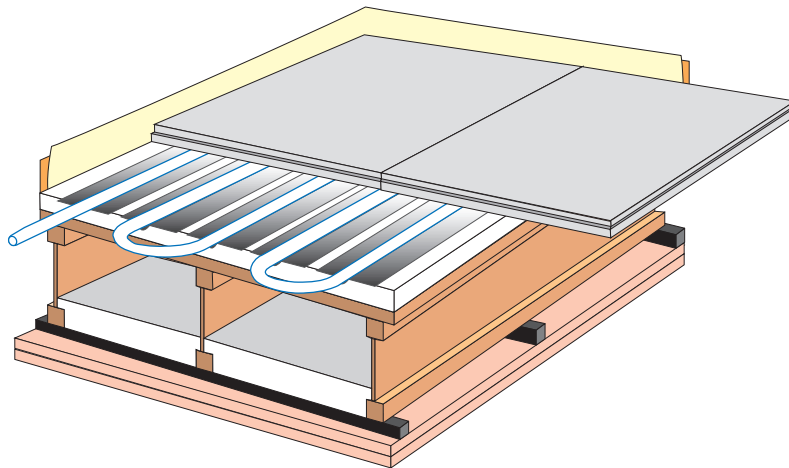

ADPK14

- Can assist in exceeding Part E requirements when correctly installed as part of an acoustic floor cassette
- Highly thermally conductive
- Low overall floor build up – 48mm + floor finish
- 25mm EPS underfloor heating grooved insulation integral to the acoustic performance of floor cassette
- Ideally complements the reduced temperatures associated with heat pumps – enhancing efficiency
- Compositional mass of floor produces high quality floor finish
- Simple dry application
- Enhanced site continuity – no drying time

Knauf board installed as shown can gain additional credits towards achieving BREEAM 'outstanding' – please contact Nu-Heat for advice.

For site-specific floor cassette detail please contact Nu-Heat.

KNAUF BRIO 23

System acoustic data

Airborne	61dB R_w
Impact	55dB L_n, w

Fire performance

From above	60mins
From below	60mins

Thermal performance

Thermal conductivity	0.38W/mK
Thermal resistance	0.06m ² K/W

Loading

Point loading	3kN*
Area loading	3kN/m ² *

* Safety factor of x2

Product density

Density	25.3kg/m ²
---------	-----------------------

HEAT OUTPUT

(m² °K/W)

Water temp	R = 0.05 (tile)	R = 0.1 (timber)	R = 0.2 (carpet)
45 °C flow (40 ° average)	75 W/m ²	71 W/m ²	63 W/m ²
55 °C flow (50 ° average)	100 W/m ² *	75 W/m ² *	94 W/m ²

Nominal value; output values vary depending on specific floor finish.

*Limited by floor covering surface temperature limit.



www.nu-heat.co.uk/floorspecs

Acoustic performance data is taken from tests carried out at the Sound Research Laboratories, Sudbury in accordance with BS EN ISO – 717.1:1997 and BS EN ISO 717.2:1997. Laboratory performances stated are specific to the above system only, inclusive of all elements shown and correct installation and should be used for guidance only. All loading data is tested in accordance with DIN 1055-3. All fire performance data and building material classes are to EN 13501-1.

The information contained in this publication is believed to be current and accurate as at the date of publication but no warranty, express or implied is given. Updates will not be issued automatically.

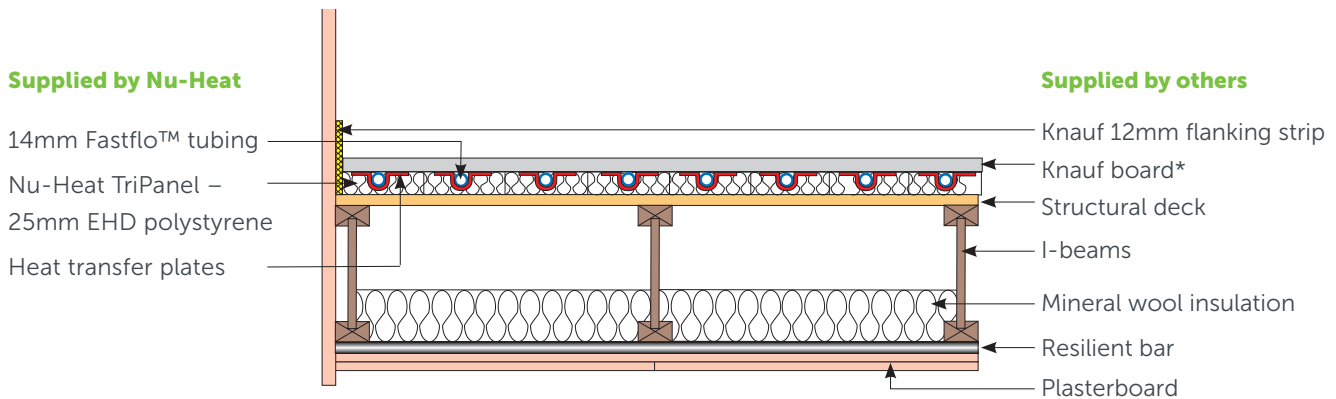

If for any reason you choose not to use Knauf board please inform Nu-Heat, as it will affect the underfloor heating design.

* Can be purchased from Nu-Heat

FLOOR HEATING TUBE

Nu-Heat's 14mm Fastflo™ tubing is extremely flexible which means that it can easily be installed around the numerous turns typical to any design. The use of multiple, shorter Fastflo™ coils within each temperature control zone means the tubing is installed at closer centres to ensure a more even heat distribution.

NU-HEAT TRI-PANEL

Tri-Panel allows full design flexibility for both pipe layout and heat output, enabling the floor construction to operate efficiently at the low flow temperatures associated with heat pumps and gas condensing boilers.

KNAUF BOARD

Knauf board is a gypsum-based composite that is capable of withstanding the temperatures involved in underfloor heating. It offers significant benefit over chipboard both acoustically and in terms of the quality feeling of the floor due to its greater density. More importantly for underfloor heating it is more conductive which enables an increased heat output.

INSULATION

If installed above unheated areas or in ground floors, insulation should be increased to at least Building Regulations Part L.

FLOOR COVERINGS

Tiles, stone and thin laminates offer benefits such as improved response time and higher heat output. A quality flexible tiling adhesive must be used for fixing floor tiles. Carpets can be used but the Tog value when combined with performance underlay should be no greater than 2.5. If the system is powered by a heat pump greater restrictions apply. Natural timber with a low moisture content can be used, but care must be taken to properly acclimatise the wood by following manufacturers' instructions.

WARRANTIES/INSURANCE

Manufacturer's warranty: all UFH tube supplied by Nu-Heat is covered by a 50-year warranty, the first 10 years of which are insurance-backed.

Product liability: Nu-Heat maintains product liability insurance to £5 million.

Professional indemnity: As Nu-Heat's design service is integral to the operational effectiveness of the UFH system, the company holds professional indemnity insurance of £5 million to cover all aspects of our consultation and design services.

www.nu-heat.co.uk/floorspecs



Online
www.nu-heat.co.uk



Freephone
0800 731 1976 or 01404 549770