

SEPHRA®

CHOCOLATE : DONUTS : CRÊPES : WAFFLES : POPCORN

4oz POPCORN MACHINE OPERATING MANUAL

VERSION 2.0.2 MAY 2018

Sephra Europe are your one-stop shop for Popcorn
Machines, Consumables, Spare Parts and Repairs.

TABLE OF CONTENTS

3	TABLE OF CONTENTS
4	IMPORTANT SAFEGUARDS
5	THE LEGEND OF SEPHRA
6	DEAR SEPHRA
7	USING THIS APPLIANCE
8	MAINTENANCE AND CLEANING

IMPORTANT SAFEGUARDS

Before using this appliance please make sure that you have read through this manual and paid particular attention to the safeguards that are listed below.

- This appliance is not to be used by persons (including children) with reduced physical, sensory or mental capabilities, or lack of experience or knowledge, unless they have been given supervision or instruction.
- Children being supervised not to play with the appliance.
- The appliance must never be left without supervision during use.
- Do not use the appliance for anything other than the purpose, which is described.
- There is a risk of accidents if accessories are used that are not recommended by the manufacturer of this appliance.
- This appliance should always be plugged into its own individual electrical outlet which has proper supply voltage, properly grounded and one that can handle the wattage rating that is identified on the rating plate on the back of the unit.
- Check the power supply cable regularly in order to detect signs of deterioration.
- Do not connect nor use any appliance with a damaged plug or cable. If the supply cord is damaged, it must be replaced by the manufacturer, its service agent or a similar qualified persons in order to avoid a hazard.
- In case of failure, the examination and repair should be performed by a qualified technician.
- All maintenance must be performed by a qualified technician.
- The appliance is not designed to be switched on by an external timer or separate remote control system.
- If you need to use an extension lead, take care to unravel the whole length in order to avoid the cable overheating.
- Always connect or disconnect the cable to the power socket with the thermostat knob set at the off position.
- Do not place the appliance on a wet surface. Do not immerse cord, plug, or appliance in water or liquids to protect against fire, electrical shock and injury to persons. Do not handle the appliance with wet hands.
- Do not let the cord hang over the edge of a table or counter.
- Do not put the appliance or its cable on or near a hot surface (electrical hotplate, hot gas burner, heated oven etc).
- Disconnect the plug when the appliance is not in use and allow to cool before cleaning.
- The appliance must not be cleaned with a high or low-pressure jet.
- Do not bleach.
- Do not handle the appliance while hot.
- Do not touch the hot surfaces.
- Leave the appliance to cool prior to handling or cleaning it.
- Place the appliance on a dry and stable surface, and slightly back from the edge and at least 20 cm from any wall or element liable to be affected by heat.
- Take care: Do not insert a sheet of tin foil or any other material or object (risk of damage) between the plate and the frame (ventilation area).
- Do not block the ventilation holes of the plastic base, under the frame.
- Caution: Do not use this device with wood, coal or other energy source than that for which it provides (electrical energy)
- We recommend you keep the original packaging in order to store the appliance.

Please make sure that you save these instructions whether for you intend to use the appliance for Domestic or Commercial purposes.

THE LEGEND OF SEPHRA

Woven among the threads of ancient Aztec legend lies the story of Sephra, an enchanting goddess whose beauty could be described only as the richness of the dark earth combined with the lustre and glow of pure gold. Her voice was softer than the most delicate flower, and her presence carried the aroma of sweet cocoa. It was Sephra who gave the ancient Aztecs the precious gift of the cocoa tree.

The legend reveals that the spirit of Sephra nourished the cocoa trees and lived within the priceless beans they produced. The Aztec kings named the cocoa tree “Theobroma Cacao,” meaning “food of the gods.” So valuable were cocoa beans that they were used to pay tribute to royalty and were given as sacred offerings to the gods.

Montezuma, the ruler of the wealthy Aztec Empire, was so enchanted by Sephra that he commissioned an elite force of skilled artisans and master craftsmen to construct a temple in her honour. As a special offering to the goddess, Montezuma built a magnificent fountain in the highest room of the temple and filled it with glistening spring water, which flowed from beneath its walls. He then surrounded the fountain with a splendid array of the most perfect cocoa beans, in hopes that Sephra would continue to bless the people with the unique and valuable crop.

So pleased was Sephra with Montezuma’s gift that she came to him in a dream and told him that her spirit would always live in the fountain he had given her. Moments later, Montezuma awoke to the sweet smell of cocoa lingering in the air. The aroma led him to the upper room of the temple where Sephra’s fountain stood.

To his astonishment, the fountain no longer flowed with water, but with the richest, purest chocolate... this was truly a gift from the gods.

For centuries, Sephra’s fountain remained hidden beneath the ruins of the ancient Aztec temple, waiting to be discovered. At long last it was, and with it was unveiled the secret of the pure, rich chocolate once coveted by gods and kings . . .

© Sephra L.P. 2003



DEAR SEPHRA CUSTOMER

Thankyou for choosing one of our appliances. It is very easy to use and we do strongly recommend that you carefully read these instructions which include advice on how to use and install your appliance in order to obtain optimum results.

RECEPTION AND UNPACKING

Any product damage due to transport must be reported to the carrier by registered letter with acknowledgement of receipt within 24 hours of receiving your appliance.

You must also note your observations on the delivery note, describing in detail the damage noticed on delivery.

ORDERING AND CONTACTING US

You can order all you need for your appliance by contacting us on +44 (0)1592 656 737.

Purchase online by visiting our company website: <http://www.sephraeurope.com>.

Any direct queries can be sent to: info@sephraeurope.com

Our mission is to help you make your Sephra appliance a very profitable aspect of your business and we look forward to assisting you.

Thankyou for choosing Sephra!

The Sephra team

USING YOUR POPCORN MAKER

It is important that the operator of this appliance should follow the instructions listed below carefully. Failure to do so may result in damage to your Popcorn Maker.

Before using the Popcorn Maker please ensure that the voltage is suitable for your country. The voltage should match the rating label specified next to the power cord.

Clean the internal surface of the **Kettle (B)**, and all the units surfaces, then hook the **Kettle (B)** onto the Hanger of the **Main Unit (A)**.

The **Main Unit (A)** has three different switches with three different functions.

1. Switch on the Light (Figure 1) in the **Main Unit (A)**.
2. Pour 2oz of oil into the **Kettle (B)** (Figure 4).
3. Pour 8oz of Popcorn kernels into the **Kettle (B)** and close the **Kettle (B)** Lid (Figure 5).
4. Switch on the Agitator and Heater (Figures 2&3).
5. The Agitator should begin to rotate (Figure 6).
6. Allow the oil to melt then add the correct measure (per instructions) of flavouring.
7. The Popcorn kernels should start to pop within a minute or two.
8. Popcorn will begin to spill out of the **Kettle (B)** onto the Heating Deck (Figure 7).
9. Switch off the Agitator and Heater (Figures 2&3) when the popping becomes less frequent.
10. Release the **Kettle (B)** from the Latch and pour the remaining Popcorn out of the **Kettle (B)** onto the Heating Deck.
11. Serve Popcorn with scoop provided.
12. Remove the plug from the power supply if the unit is not being used for a long time.
13. Repeat the above steps for more Popcorn.

Figure references 1 to 7

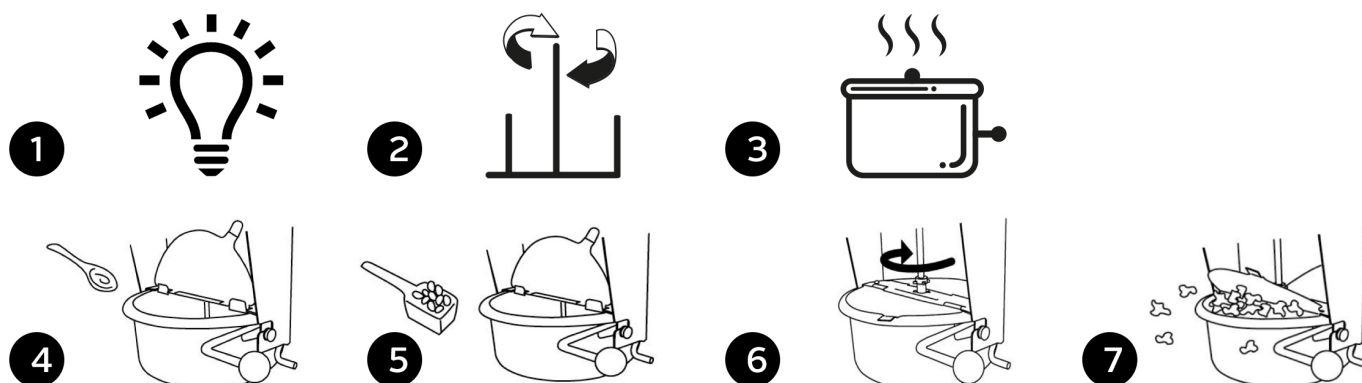

MAINTENANCE AND CLEANING

Before cleaning your appliance please ensure that you have unplugged it from the mains supply and allowed it to cool down. read the general rules applicable to electrical equipment before taking any action on the appliance.

THE FRAME

- Clean the Frame with a damp warm cloth and diluted liquid detergent.
- Never use abrasive products or metallic brushes.
- Do not clean the appliance under flowing water.
- Do not immerse the appliance.

THE KETTLE

Disconnect the unit from the power supply and wait until the unit has cooled down before you begin with any maintenance or cleaning procedures. Food residues or spots on the surfaces have to be cleaned immediately (make sure not to burn yourself as the unit could still be hot) or at the latest before operation. Use a damp cloth for cleaning if only slight residue has to be removed. If this is not sufficient please wait until all parts of the unit have become cold and clean with an appropriate, non-abrasive, detergent. Never submerge the **Kettle (B)** in water.

Sephra would advise you to use **Heat'n'Kleen Kettle Cleaner**.

Heat'n'Kleen is safe and simple to use. Its outstanding detergency emulsifies grease and oil and will soften hard carbon deposits that build up within the **Kettle (B)** making it easy for removal. An 879g tub of **Heat'n'Kleen** will provide you with many **Kettle (B)** cleans.

Use 2oz of **Heat'n'Kleen** per gallon of water for moderate soils. For heavy duty cleaning up to 4 ounces may be used per gallon.

SEPHRA[®]

CHOCOLATE : DONUTS : CRÊPES : WAFFLES : POPCORN

Tel: +44 (0)1592 656 737 / Fax: +44 (0)1592 653 535

Web: www.sephra.co.uk / Email: info@sephra.co.uk

Sephra Europe, Unit 2, Block 9, Muirhead, Mitchelston Industrial Estate, Kirkcaldy, Fife, Scotland KY1 3PE